



Recorder



Flow



Pressure



Temp



Analyzer



Level

Datasheet

Turbidity Sensor

SIN-PTU-8011

Sinomeasure

Committed to process automation solutions

Tel: 86-13336194863

E-mail: info@sinomeasure.com

www.sino-measure.com

Datasheet**Turbidity Sensor
SIN-PTU-8011**

SIN-PTU-8011 turbidity sensor based on the infrared absorption scattered light method and combined with the application of ISO7027 method, can guarantee the continuous and accurate detection of turbidity. Based on ISO7027, infrared double scattering light technology will not be affected by chroma for the measurement of turbidity value. According to the usage environment, self-cleaning function can be equipped with. It assures the stability of data and reliability of performance; with the built-in self-diagnosis function, it can make sure the accurate data be delivered; besides, the installation and calibration is quite simple.

Applications

- Wastewater
- Tap water
- Water Station
- Surface water
- Industry water
- Environmental monitoring

Features

- Measure range: 0.01~4000NTU
- Accuracy: Less than $\pm 2\%$ or ± 0.1 NTU of the measured value (Take the maximum)
- Pressure range: ≤ 0.4 MPa
- Working temperature: 0~45°C (No ice)
- RS485 communication

**Turbidity Sensor**

Parameters	
Specification	Detailed information
Measurement range	(0.01 to 4000) NTU
Measurement accuracy	Less than $\pm 2\%$ of measured value or ± 0.1 NTU, take the maximum
Repeatability	$\pm 2\%$
Resolution	(0.01~0.1)NTU, depending on the range
Pressure range	≤ 0.4 Mpa
Flow rate	≤ 2.5 m/s、8.2ft/s
Main materials	Body: SUS316L/Titanium/PVC; top and bottom cover: POM, cable: PUR
Power supply	12VDC
Output	RS485, MODBUS-RTU
Operating temperature	(0~45) $^{\circ}$ C (No Icing)
Weight	1.65kg
Ingress Protection	IP68/ NEMA6P
Cable length	10m cable (standard), 100m (extended)

Installation

Connections of Sensor					
Core Number	1	2	3	4	5
Wire of Sensor	Brown	Black	Blue	White	Yellow + Green
Signal	+12VDC	AGND	RS485 A	RS485 B	Earth Line

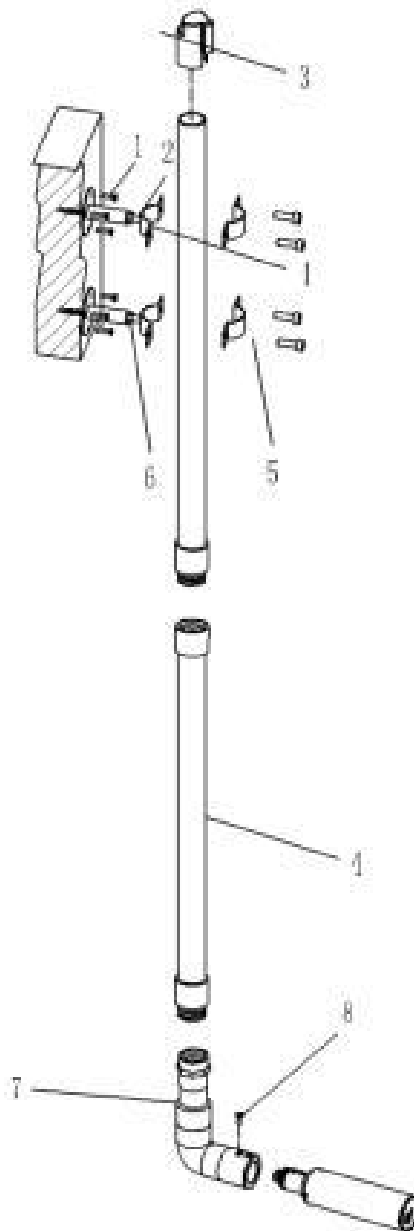
Installation**■ Classic Poolside Fixed Installation****CBJD-03**

No.	Parts
1	Expansion screws
2	Installation of pipes
3	Installation see blockage
4	Installing the pipe
5	Hexagon socket screws
6	Flange nuts
7	Sensor adaptor
8	Cross bolt M6*12

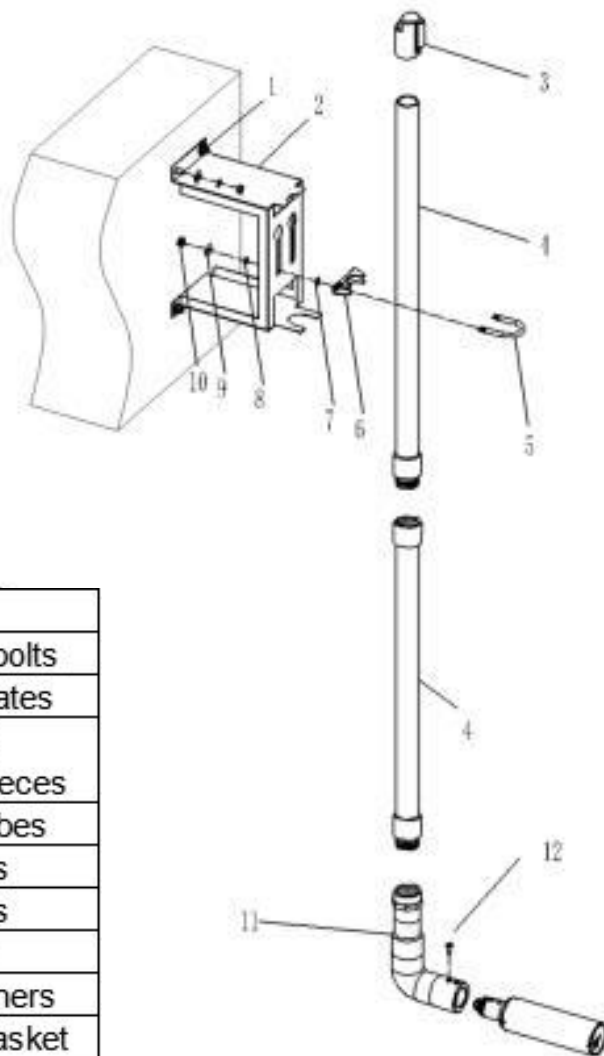
■ Quick Release Poolside Fixed Installation**CBZJ-03**

No.	Parts
1	Expansion bolts
2	Mounting plates
3	Clogging of mounting pieces
4	Mounting tubes
5	Pipe clamps
6	Pipe clamps
7	Flat gasket
8	Spring washers
9	Large flat gasket
10	Flange nuts
11	Sensor adapters
12	Cross bolt M6*12

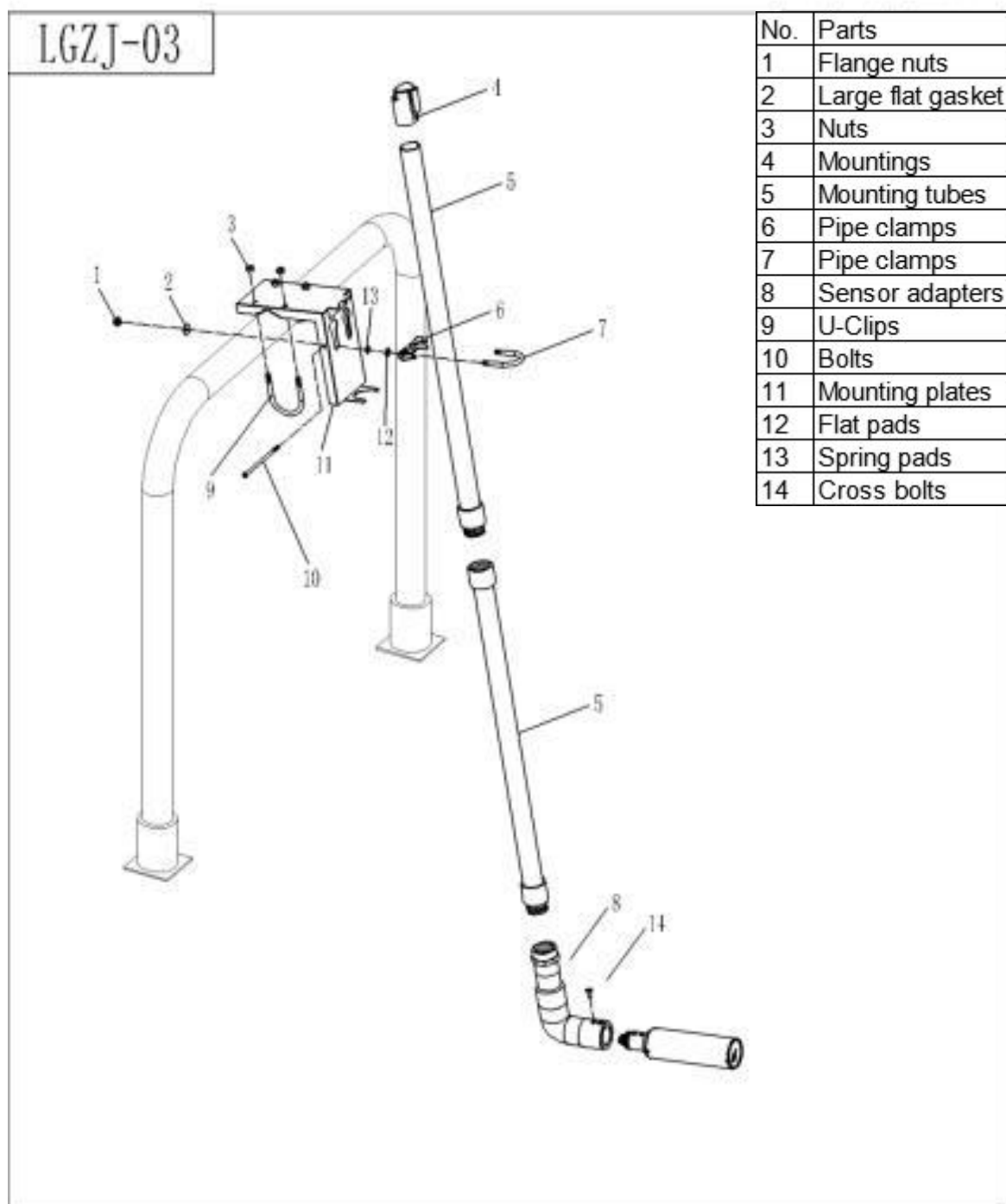
■ Railing Type Fixed Installation

Dimension

■ **With Scraper Sensor**

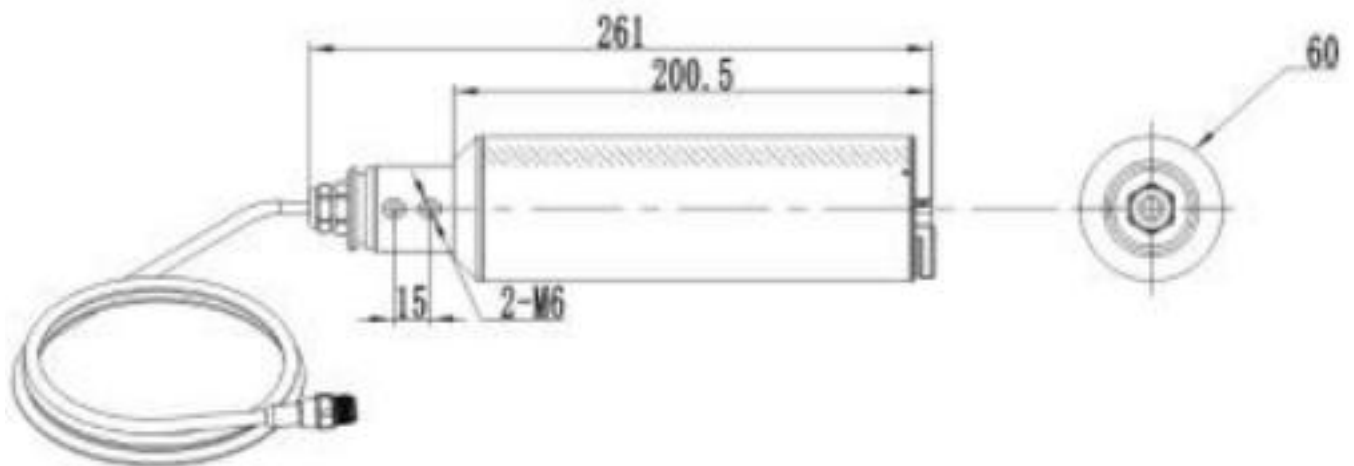

■ **Without Scraper Sensor**

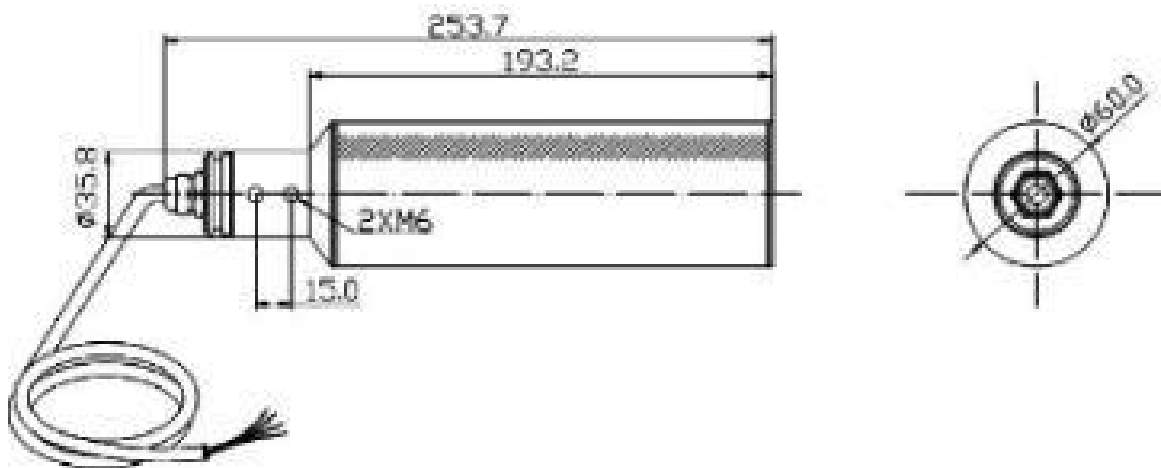

Dimension

SIN-PTU8011-HM1-ES0-CS10										Description
SIN-PTU8011	-	-	-	-	-	-	-	-	-	
Serial Number PTU8011										Measuring range: (0.01~4000)NTU Temperature range: (0-45)℃ Pressure resistance: 0.2MPa
Shell material	HM1									Stainless steel housing
	HM2									Titanium shell
Electrode scraper	ES0									Without electrode scraper
	ES1									With electrode scraper
Cable length	CS10									10 cables
	CSXX									XXm cable